

## SERIES 270

## CONTACT POINTS

### type A

Code	Material	L(mm)
270-001-01	carbide	7.3
270-001-02	ceramic	7.3
270-001-03	carbide	8.3
270-001-04	carbide	12.1
270-001-05	carbide	14
270-001-06	carbide	15
270-001-07	ceramic	15
270-001-08	carbide	17
270-001-09	carbide	19.3
270-001-10	carbide	20
270-001-11	ceramic	20
270-001-12	carbide	22
270-001-13	carbide	25
270-001-14	ceramic	25
270-001-15	carbide	30
270-001-16	ceramic	30

### Ball Point



270-001-03

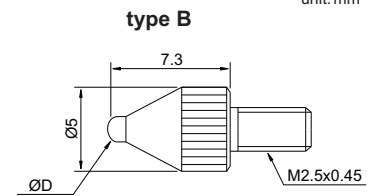
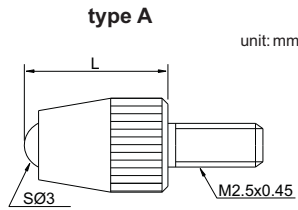

unit: mm

### type B

Code	Material	ØD(mm)
270-001-21	steel	1
270-001-22	carbide	1.5
270-001-23	carbide	1.8
270-001-24	carbide	2.5
270-001-25	carbide	4

### Shell Type Point



270-002-02

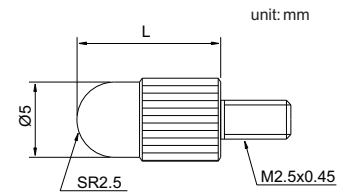

unit: mm

Code	Material	L(mm)
270-002-01	steel	5
270-002-02	steel	10
270-002-03	steel	15
270-002-04	steel	20
270-002-05	steel	25
270-002-06	steel	30

### Spherical Point

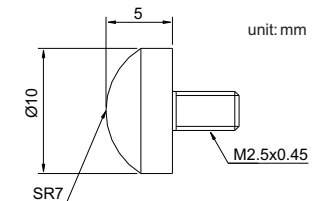

unit: mm

Code	Material
270-003-01	steel

### Conical Point



270-004-02

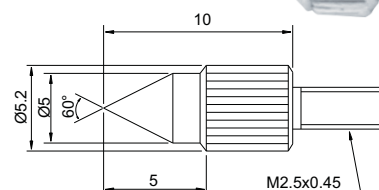

270-004-01

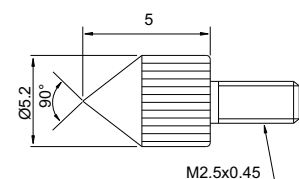

270-004-02

unit: mm

Code	Material
270-004-01	steel
270-004-02	steel



## CONTACT POINTS

## SERIES 270

### Flat Point



270-005-12



270-010-16

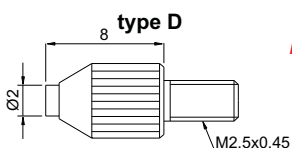
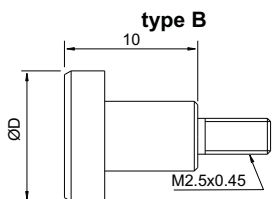
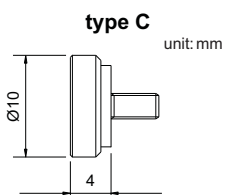
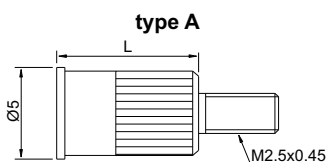

NEW

#### type A

Code	Material	L
270-005-01	steel	8
270-005-02	steel	10

#### type B

Code	Material	ØD
270-005-11	steel	10
270-005-12	steel	15
270-005-13	steel	20
270-005-14	steel	25
270-005-15	steel	30
270-010-16	ceramic	10

#### type C

Code	Material	ØD
270-010-16	ceramic	10

#### type D

Code	Material
270-005-21	carbide

### Needle Point



270-006-16



270-006-22

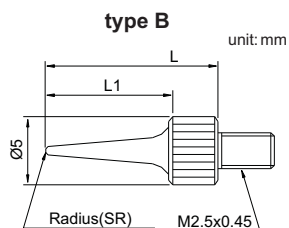
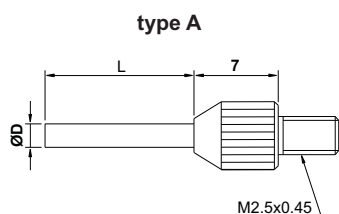

#### type B

Code	Material	L1	L	SR
270-006-21	steel	11	15	0.4
270-006-22	steel	13	17	0.2
270-006-23	steel	21	25	0.4
270-006-24	steel	31	35	0.4

#### type A

Code	Material	ØD	L
270-006-01	steel	0.45	3
270-006-02	steel	0.45	5
270-006-03	carbide	1	3
270-006-04	carbide	1	5
270-006-05	carbide	1	8
270-006-06	carbide	1	10
270-006-07	carbide	1	20
270-006-08	carbide	1	40
270-006-09	carbide	1.5	5
270-006-10	carbide	1.5	10
270-006-11	carbide	1.5	13
270-006-12	carbide	1.5	20
270-006-13	carbide	1.5	40
270-006-14	carbide	2	8
270-006-15	carbide	2	18
270-006-16	carbide	2	28
270-006-17	carbide	2	40

### Knife Edge Point

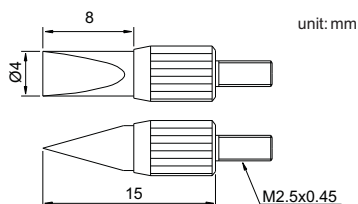

Code	Material
270-007-01	steel

